



Burgess Hill Town Council  
Bus Forum

12<sup>th</sup> October 2022

# Place & Connectivity Programme

Burgess Hill Bus Stop and RTPI Improvements

Liz Clark – BHTC

Paul Jackson-Cole - WSCC

Liz Robbins - WSCC

# Burgess Hill Place and Connectivity Programme

- £10.92m LGF funding for the Burgess Hill Place and Connectivity Programme to:
- Support sustainable economic growth by:
  - Creating safe, direct and attractive routes to encourage greater use of walking, cycling and public transport
  - Enhancing public transport interchanges
  - Creating high quality public realm
  - Delivering modal shift
- Support the Burgess Hill Strategic Growth Programme
- Match funded with £10.92m of developer contributions (£21.8m funding)



# Burgess Hill Place and Connectivity Programme

## Priority Projects Phase 1

- Burgess Hill Green Circle (4.35km delivered)
- Burgess Hill Townwide Connectivity (7km delivered)
- Wivelsfield Bridge Public Realm (delivered)
- A2300 Ped / Cycle and Bridleway Links ( 3.5km delivered)
- Burgess Hill Station and Western Gateway Improvements (in delivery 22/23)
- Wivelsfield Station Improvements (in delivery 22/23)



# Burgess Hill Place and Connectivity Programme

## Priority Projects

### Phase 2

- Project Appraisal and Prioritisation Spring 22
- Growth Board / Member Steering Group Endorsement of project & budget Summer 22
- Working up Stakeholder and Public Engagement Material Autumn 22
  
- Key project in Phase 2 – **Bus Stop and RTPI Improvements**
  
- 6 RTPI screens already installed through WSCC and BHTC
- Place & Connectivity Programme proposals will expand the network of RTPI and improvements to identified bus stops

# Burgess Hill Place and Connectivity Programme

## Bus Stop and RTPI Improvements

- Identification of bus stops that may benefit from RTPI and Potential to enhance Bus Stops – Burgess Hill Sustainable Transport Study - 2016

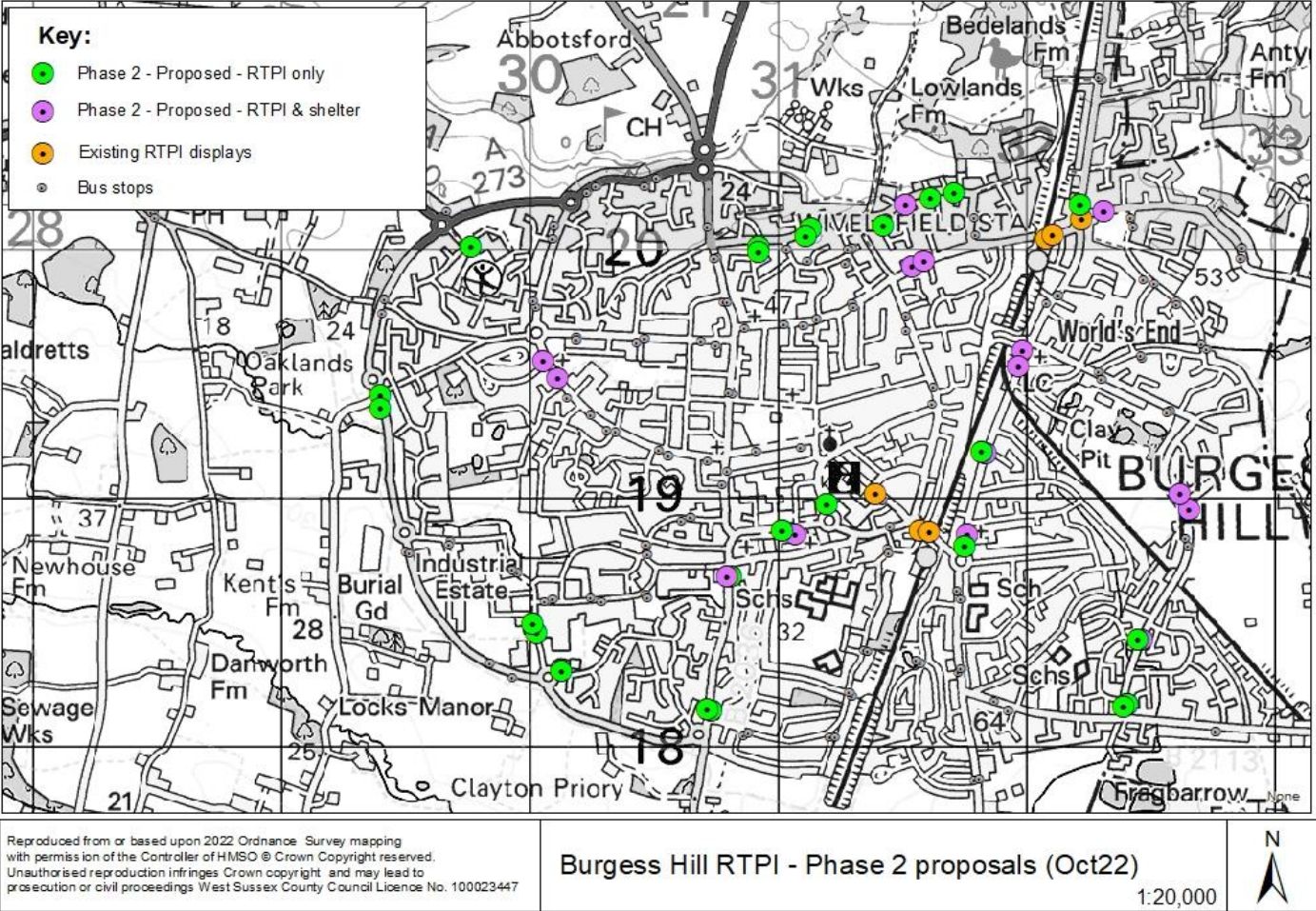

# Burgess Hill Place and Connectivity Programme

## Bus Stop and RTPI Improvements

- Bus Stop Options – Improve and Install where achievable with an Identity for BH
- Potential for Solar, Battery or Mains dependent upon specification

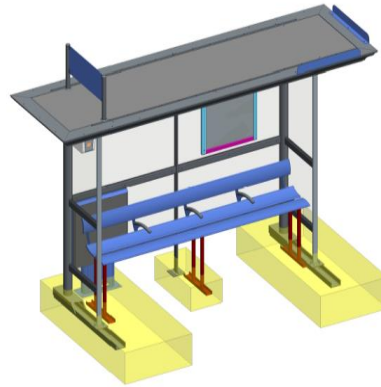

- RTPI screens at identified stops providing an Identity for BH
- Power options – install new feeder pillar or battery power options
- Option for Audio to support Inclusive Town Initiative





# Burgess Hill Place and Connectivity Programme

## Bus Stop and RTPI Improvements – Next Steps

- Bus Forum to agree approach and proposals for Bus Stop and RTPI Improvements
- Officers to finalise project scope and costs
- WSCC to prepare Business Case and Governance - project budget, deliverables and benefits
- Funding Agreement - Burgess Hill Town Council procure and deliver Improvements

## Wider Bus Stop and RTPI Improvements

- Church Road Public Realm Improvements – Shelters and RTPI within scope of project
  - Wider Public Realm Improvements – bus stop ‘hub’
  - Opportunity for Solar and / or Green Roof
- Station Road and Queen Elizabeth Avenue – Working with Clear Channel and BHTC:
  - Relocated Bus Stop / RTPI on Station Road
  - New Bus Stop / RTPI on Queen Elizabeth Avenue northern footway